

Planning Permit No. A/257191

APPROVED

SUBJECT TO THE CONDITIONS IN THIS OFFICE LETTER.

DD No. A2/26499/90 Date 12.3.91

S. Jayaram

FOR MEMBER SECRETARY
MADRAS METROPOLITAN
DEVELOPMENT AUTHORITY
MADRAS - 600 009

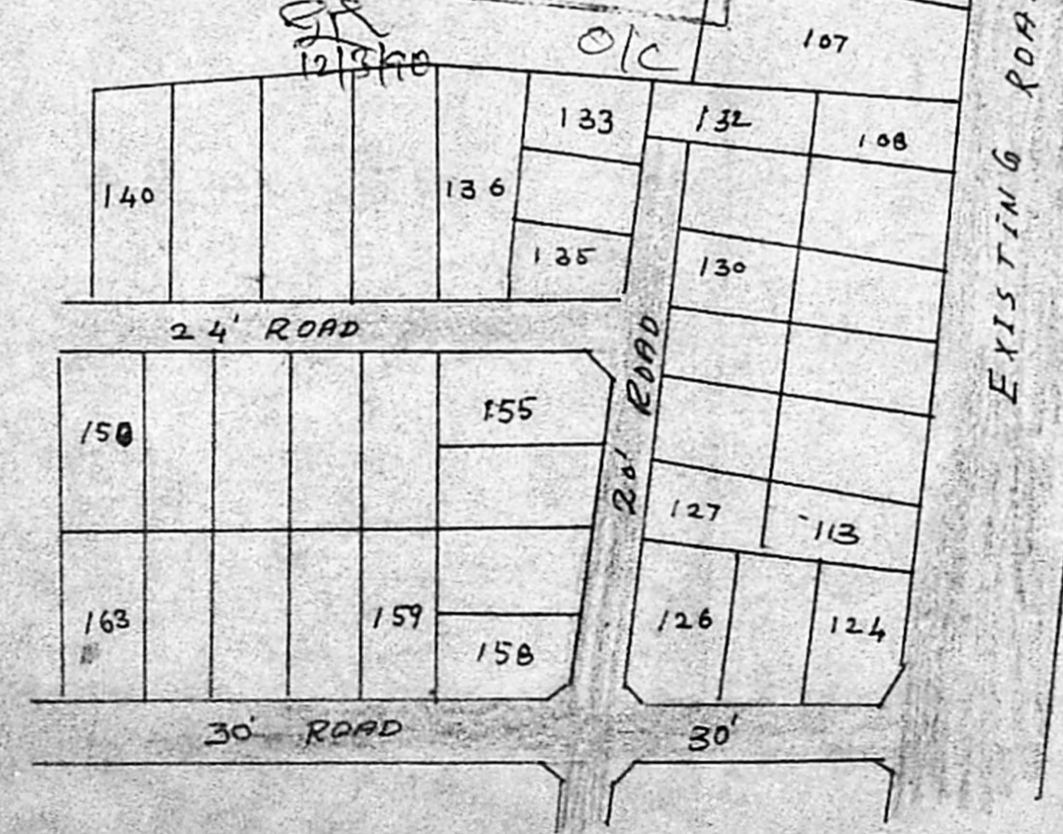

PLAN SHOWING THE PROPOSED CONSTRUCTION OF BUILDING AT 135 B, MAJESTIC COLONY, S.NO. 160/1A1 (PART) VALASARA VAKKAM VILLAGE, SAIDAPET TK, CHENGLEPUT DT. SCALE 1:48

AREA OF DETAILS

PLOT AREA 1388 sq ft 129 m²
 PLOT COVERAGE 619.70 sq ft 57.2 m²
 F.S.I. 4.6.10 % Inspection Copy

JOINARY DETAILS

D DOOR	3'3" x 6'6"	99	Xr. 198 No.	PPA/208/90
D1	3'0" x 6'6"	91	X 198	
D2	2'6" x 6'6"	76	X 198	Officer
D3	2'0" x 6'6"	61	X 198	6/12/90
W WINDOW	5'0" x 4'0"	152	X 122	
W1	3'0" x 4'0"	91	X 122	
V VENTILATOR	3'0" x 1'6"	91	X 46	Executive Officer

G. Diwanathan Pillai
 Engineer, Licensed Surveyor
 Corporation of Madras City
 Class II, 188
 136, Chinmay Nagar, II
 MADRAS - 600 092

OWNER LICENCED SURVEYOR

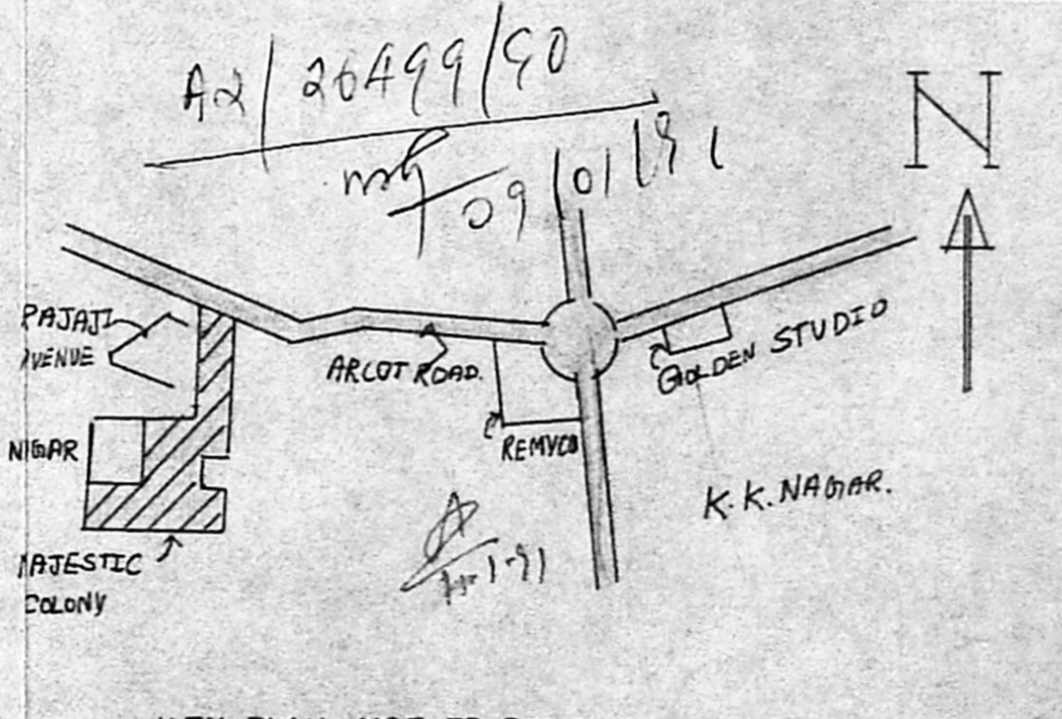

Graveled
 Street lights were provided